

Pro/ENGINEER Wildfire 4.0 Update from Pro/ENGINEER Wildfire 2.0

Overview

Course Code TRN-2172-T

Course Length 2 Days

In this course, you will learn how to utilize many of the enhancements to core functionality in Pro/ENGINEER Wildfire 4.0. This course is intended as an update directly from Pro/ENGINEER Wildfire 2.0 to Pro/ENGINEER Wildfire 4.0, so some of the enhancements covered in this course were introduced in the Pro/ENGINEER Wildfire 3.0 release. You will become familiar with enhancements to Part mode, including embedded datum creation, and warp and partial shell features. You will learn new methods for creating features such as swept blends, and new methods for placing user defined features. You review new capabilities for feature manipulation, such as enhanced patterning capabilities. You will become familiar with the enhancements to Sketcher, such as how to copy and paste items in sketcher and how to insert predefined shapes such as polygons and common engineering sections, such as I-beams. You will also learn how to reference intent objects and replace sketcher references. You will learn about new and enhanced Assembly capabilities such as the Global Reference Manager and the new user interface for assembling components. You will use new drawing functionality, including how to create shaded drawing views. You will also learn about sheetmetal enhancements including how to create multiple walls in a single operation.

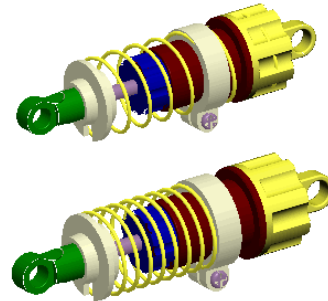

Course Objectives

- Describe and utilize Part enhancements.
- Describe and utilize Sketcher enhancements.
- Describe and utilize Assembly enhancements.
- Describe and utilize Drawing enhancements.
- Describe and utilize Sheetmetal enhancements.

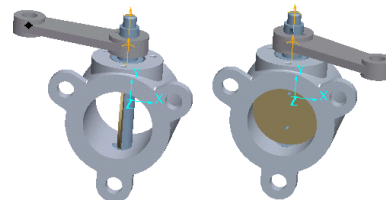

Prerequisites

- Completion of T1707-340 Pro/ENGINEER Wildfire 2.0 Update or equivalent experience.

Audience

- This course is intended for people who have already upgraded to Pro/ENGINEER Wildfire 2.0, and who are moving directly to Pro/ENGINEER Wildfire 4.0.

Agenda

Day 1

Module	1	Part Enhancements
--------	---	-------------------

Module	2	Part Feature Duplication Enhancements
--------	---	---------------------------------------

Module	3	Sketcher Enhancements
--------	---	-----------------------

Day 2

Module	4	Assembly Component Enhancements
--------	---	---------------------------------

Module	5	Advanced Assembly Enhancements
--------	---	--------------------------------

Module	6	Drawing Enhancements
--------	---	----------------------

Module	7	Sheetmetal Enhancements
--------	---	-------------------------

Course Content

Module 1. Part Enhancements

- i. Navigator and Browser Enhancements
- ii. File Open Dialog Enhancements
- iii. Parameters Dialog Box Enhancements
- iv. One-By-One Selection
- v. Exact Relation
- vi. Asynchronous Curve Creation
- vii. Draft Enhancements
- viii. Extend Enhancements
- ix. Swept Blend Dashboard
- x. Swept Blend Enhancements
- xi. Warp Enhancement
- xii. Embedded Datum Features
- xiii. Intent Datum Features Enhancements
- xiv. Merge Enhancements
- xv. Partial Shell Option
- xvi. Shell Enhancements
- xvii. Hole Profile Options
- xviii. Tapered Holes and Pipe Threads
- xix. Cosmetic Thread Enhancements
- xx. Remove Surface Feature
- xxi. Auto Round
- xxii. Part Parent/Child Information Enhancements

Module 2. Part Feature Duplication Enhancements

- i. UDF Enhancements
- ii. Intent-Based UDFs
- iii. Copy/Paste Enhancements
- iv. Group Enhancements
- v. Creating Curve Patterns
- vi. Fill Pattern Enhancements
- vii. Creating a Pattern of Patterns
- viii. Moving/Mirroring Patterns
- ix. Reference Pattern Enhancements

Module 3. Sketcher Enhancements

- i. Default Diameter Dimensions
 - ii. Locked/Modified Dimensions Enhancement
 - iii. Auto-Locking Dimensions
 - iv. Sketcher Line Style and Color
 - v. New Sketcher Workflow
-

- vi. Undo/Redo Reorient View
- vii. Using Cut/Copy/Paste in Sketcher
- viii. New Sketcher Palette
- ix. Sketched Text Enhancements
- x. Sketcher Intent Object Referencing
- xi. Replacing Sketcher References
- xii. Sketcher Diagnostic Tools

Module 4. Assembly Component Enhancements

- i. Component Assembly UI Enhancements
- ii. Using the Component Dashboard for Constraints
- iii. Using the Component Dashboard for Connections
- iv. Component Transparency Enhancements
- v. Component Dashboard Options
- vi. Component Drag Enhancements
- vii. Active Component Enhancements
- viii. Creating Component Interfaces
- ix. Placing Single and Multiple Components using Interfaces
- x. Placing Components with Interface Rules

Module 5. Advanced Assembly Enhancements

- i. Zone Enhancements
- ii. Axis Alignment Enhancements
- iii. Clipped State Enhancements
- iv. Frozen Component Enhancements
- v. Assembly Family Table Enhancements
- vi. Data Sharing UI Enhancements
- vii. Miscellaneous Assembly Enhancements
- viii. Flexible Component Enhancements
- ix. Simplified Representation Enhancements
- x. Global Reference Viewer
- xi. Replace Component Enhancements

Module 6. Drawing Enhancements

- i. Drawing Template Enhancements
 - ii. Shaded Views
 - iii. View States
 - iv. 3-D Sections
 - v. Drawing Layer Enhancements
 - vi. Aligning and Centering Dimensions
 - vii. Diameter and Radius Dimension Enhancements
 - viii. Ordinate Dimension Enhancements
 - ix. Dimension Clipping Enhancements
-

- x. Drawing Annotation Enhancements
- xi. Detailing Enhancements
- xii. Cross Section Enhancements
- xiii. Full Unfold Cross Section Enhancements
- xiv. Set Datum and Control Frame Enhancements
- xv. GTOL Enhancements
- xvi. Dimension and Tolerancing Enhancements
- xvii. Modify Model Edges Enhancement
- xviii. View Name Placement Enhancements
- xix. Offset Notes Improvements
- xx. Tapered Thread Enhancement
- xxi. Converting Draft Entities Improvement
- xxii. Draft Datum Improvements
- xxiii. Draft Entities Improvements
- xxiv. Bill Of Material Enhancements

Module 7. Sheetmetal Enhancements

- i. Sheetmetal Reports in Browser
 - ii. Annotation Planes for Bend Notes
 - iii. Sheetmetal Default Accuracy and Thickness Parameter
 - iv. Unattached Flat Wall Enhancements
 - v. User-Defined Flat Wall Sections
 - vi. Unattached Extruded Wall Enhancements
 - vii. Flange Walls on Non-Tangent Edges
 - viii. Flange Walls with Mitered Corners
 - ix. User-Defined Flange Wall Sections
 - x. Solid and Sheetmetal Cuts
 - xi. Add to Part Edge Option
-